

O:\Greene Cnty Eng\011918A.00 - GRE-Old Stage Road Bridge\Drawings\Sheet\012_00791_SF001.dgn 7/31/2018 3:47:25 PM jmeliman



CURVE 2 DATA

P.I. Sta. 3+41.06
 $\Delta = 42^\circ 29' 11''$ (LT)
 $D_c = 14^\circ 19' 26''$
 $R = 400.00'$
 $T = 155.50'$
 $L = 296.61'$
 $E = 29.16'$
 $C = 289.86'$
 C.B. = N $22^\circ 38' 34''$ E

CURVE 3 DATA

P.I. Sta. 7+73.78
 $\Delta = 29^\circ 15' 02''$ (RT)
 $D_c = 22^\circ 55' 06''$
 $R = 250.00'$
 $T = 65.24'$
 $L = 127.63'$
 $E = 8.37'$
 $C = 126.25'$
 C.B. = N $16^\circ 01' 30''$ E

BENCHMARK DATA

BM #1 STA. 3+95.09 , ELEV. 833.28 , OFFSET 8.44' , RT
 BM #2 STA. 7+35.68 , ELEV. 827.79 , OFFSET 7.79' , LT
 BM #3 STA. 6+41.55 , ELEV. 826.84 , OFFSET 13.69' , RT

NOTES

- EARTHWORK LIMITS SHOWN ARE APPROXIMATE.
- PROVIDE 6" OF ITEM 304 UNDERNEATH APPROACH SLABS WITH A 6" STEP ON EACH SIDE.
- PROVIDE PAVEMENT STEPS IN ACCORDANCE WITH ODOT SCD BP-3.1.

LEGEND

- 1.5" 441 AC SURFACE TYPE 1 (448) P664-22
- 1.5" ASPHALT CONCRETE INTERMEDIATE COURSE, TYPE 1 (448)
- 407 TACK COAT (0.1 GAL/S.Y.)
- 6" 301 BITUMINOUS AGGREGATE BASE
- 6" 304 AGGREGATE BASE

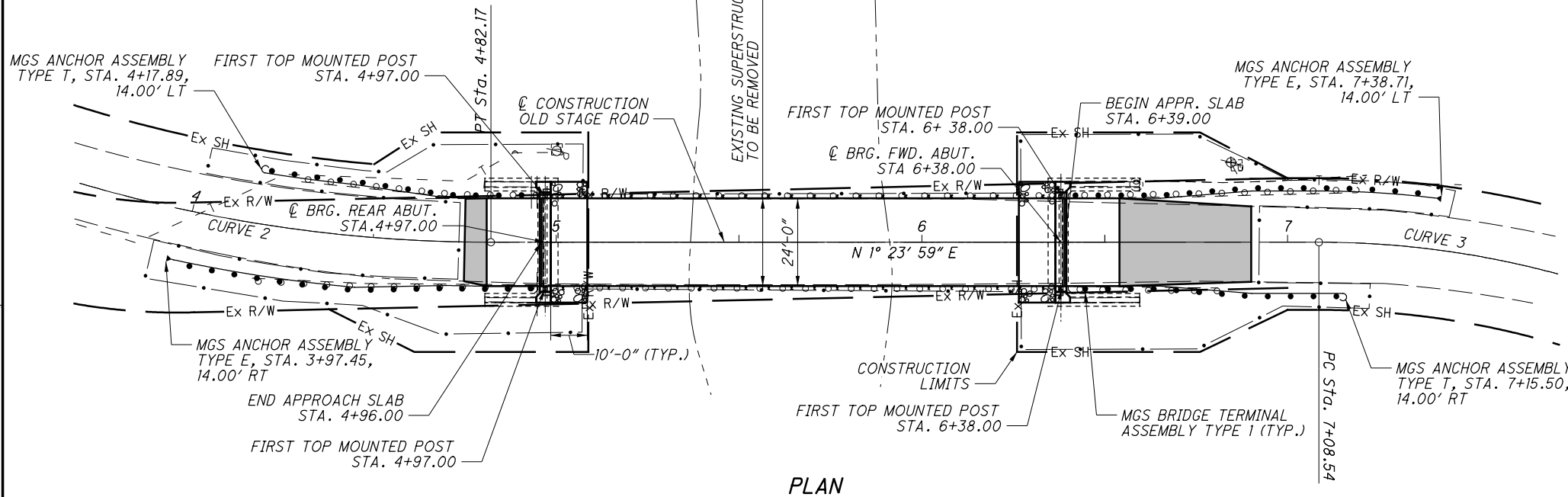

PLAN

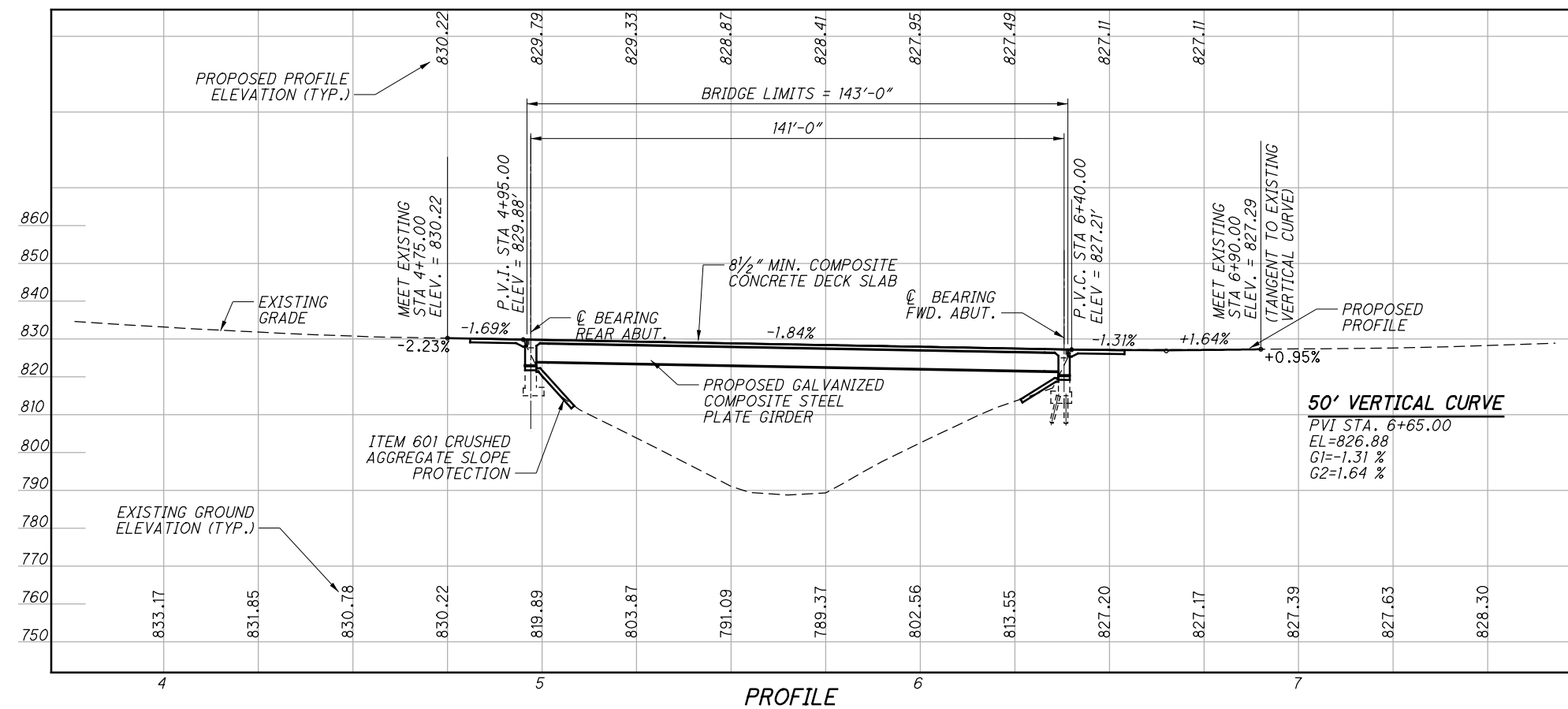

PROFILE

EXISTING STRUCTURE

TYPE: STEEL TRUSS BRIDGE WITH ASPHALT WEARING SURFACE ON REINFORCED CONCRETE "U" TYPE ABUTMENTS

SPANS: 140'-0" C/C BEARINGS
 ROADWAY: 24'-0" F/F RAILING
 LOADING: HS20-44
 SKEW: NONE
 APPROACH SLABS: NONE
 ALIGNMENT: TANGENT
 CROWN: 1/4 IN/FT
 STRUCTURAL FILE NUMBER: 2932717
 DATE BUILT: 2000
 DISPOSITION: REPLACE SUPERSTRUCTURE

PROPOSED STRUCTURE

TYPE: SINGLE SPAN GALVANIZED COMPOSITE STEEL PLATE GIRDER BRIDGE WITH REINFORCED CONCRETE DECK ON SEMI-INTEGRAL ABUTMENTS
 SPANS: 141'-0" C/C BEARINGS
 ROADWAY: 24'-0" F/F RAILING
 LOADING: HL93 AND FUTURE WEARING SURFACE OF 60 PSF
 SKEW: NONE
 APPROACH SLABS: 15'-0" LONG (AS-1-15)
 ALIGNMENT: TANGENT
 CROWN: 0.021 FT/FT
 STRUCTURE FILE NUMBER: 2932717
 COORDINATES: LATITUDE 39°34'58.97"
 LONGITUDE 84°02'26.62"

| | | | | | | | | |
|--|----------------------------------|-----------------|--------------|------------------------|---|--|----------------|-------|
| DESIGN AGENCY JLB Inc. • 2500 Newmark Drive Miamingburg, OH 45342 937.295-0000 (tel) • (937) 295-5100 (fax) • jlb@jlb.com | DATE 08-18 | REVIEWED DWS | DRAWN NRP | DESIGNED NRP | GREENE COUNTY STA. 4+96.00 STA. 6+39.00 | SITE PLAN GRE-T0120-00790 OLD STAGE ROAD OVER BEAR RUN | GRE-T0120-0079 | 1 / 4 |
| | STRUCTURE FILE NUMBER 2932717 | CHECKED JLM | REVISED | FILE NUMBER 2932717 | | | 2 5 | |

UTILITIES

LISTED BELOW ARE ALL UTILITIES LOCATED WITHIN THE PROJECT CONSTRUCTION LIMITS TOGETHER WITH THEIR RESPECTIVE OWNERS:

| Utilities Contacted by OUPS | Utility Contact | Utility Contact Number |
|--|---|------------------------|
| Greene County Water 667 Dayton-Xenia Road Xenia, Ohio 45385 | Tim Grow tgrow@co.greene.oh.us Mark Schulker mschulker@co.greene.oh.us | Phone: (937) 562-7462 |
| Greene County Sanitary 667 Dayton-Xenia Road Xenia, Ohio 45385 | Tim Grow tgrow@co.greene.oh.us Mark Schulker mschulker@co.greene.oh.us | Phone: (937) 562-7462 |
| AT&T 3233 Woodman Drive, Room 225 Kettering, Ohio 45420 | Howard Laudermilk HL1596@att.com | Phone: (937) 296-3588 |
| Dayton Power & Light Co. 1900 Dryden Rd. Dayton, OH 45439 | Eric Parris Eric.Parris@ijus.net | Cell: (937) 238-1716 |
| Bridgewired Street Address Waynesville, OH 45068 | Engineer Name support@bridgewired.com | Phone: (513) 855-0210 |

THE LOCATION OF THE UNDERGROUND UTILITIES SHOWN ON THE PLANS ARE AS OBTAINED FROM THE OWNERS AS REQUIRED BY SECTION 153.64 O.R.C.

SURVEY PARAMETERS

PRIMARY PROJECT CONTROL MONUMENTS GOVERN ALL POSITIONING ON ODOT PROJECTS. SEE SHEET OF THE PLANS FOR A TABLE CONTAINING PROJECT CONTROL INFORMATION.

USE THE FOLLOWING PROJECT CONTROL, VERTICAL POSITIONING, AND HORIZONTAL POSITIONING PARAMETERS FOR ALL SURVEYING:

PROJECT CONTROL
POSITIONING METHOD: ODOT VRS
MONUMENT TYPE: MAG NAIL
VERTICAL POSITIONING
ORTHOMETRIC HEIGHT DATUM: NAVD 88
GEOID: GEOID 2012A (CONUS)
HORIZONTAL POSITIONING
REFERENCE FRAME: NAD 1983 (2011)

ELLIPSOID: GRS80
MAP PROJECTION: LAMBERT CONFORMAL CONIC
TWO PARALLEL
COORDINATE SYSTEM: US STATE PLANE 1983 (2011), OHIO
SOUTH ZONE
COMBINED SCALE FACTOR: 1.000000
PROJECT ADJUSTMENT FACTOR: 1.000000
ORIGIN OF COORD. SYSTEM: 0,0
USE THE POSITIONING METHODS AND MONUMENT TYPE USED IN THE ORIGINAL SURVEY TO RESOTRE ALL MONUMENTS RELATED TO PRIMARY PROJECT CONTROL THAT ARE DAMAGED OR DESTROYED BY CONSTRUCTION ACTIVITIES. RESTORE THE DAMAGED OR DESTROYED MONUMENTS IN ACCORDANCE WITH CMS 623 CONSTRUCTION LAYOUT STAKES AND SURVEY MONUMENTS.

UNITS ARE IN U.S. SURVEY FEET.
USE THE FOLLOWING CONVERSION FACTOR:
1 METER = 3.280833333 U.S. SURVEY FEET

Q:\Greene_Cnty_Eng\011918A.00 - GRE-Old Stage_Road_Bridge\Dev\Drawings\Str\sheets\012_0079t_SN001.dgn 7/31/2018 3:47:26 PM jmelman

| | | | | |
|---|---------------------|---|----------------------|---|
| DESIGNED NRP | DRAWN NRP | REVIEWED DWS | DATE 08-18 | DESIGN AGENCY LIB Inc. • 2500 Newmark Drive Miamisburg, OH 45342 1937 296-4000 (tel) • 1937 296-5100 (fax) • LIBinc.com |
| CHECKED JLM | REVISED | STRUCTURE FILE NUMBER 2932717 | | |
| GENERAL NOTES | | | | |
| GRE-T0120-00790 OLD STAGE ROAD OVER BEAR RUN | | | | |
| GRE-T0120-0079 | | | | |
| 2 / 4 | | | | |
| 3 5 | | | | |

Q:\Greene Nty_Eng\011918A.00 - GRE-Old Stage Road Bridge\Dev\Drawings\Str\sheets\012_0079T_AR001.dgn 7/31/2018 3:47:27 PM jmelman

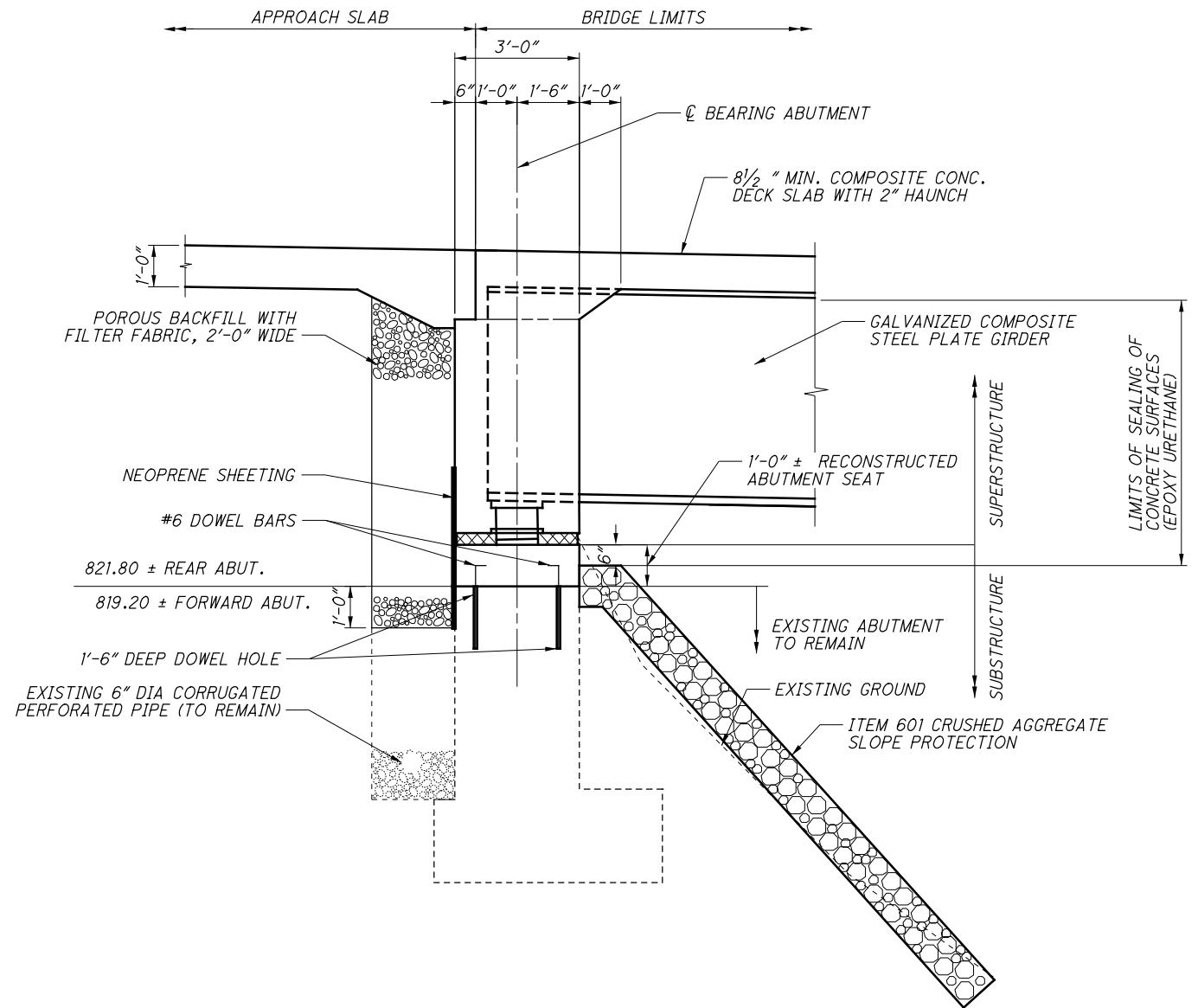
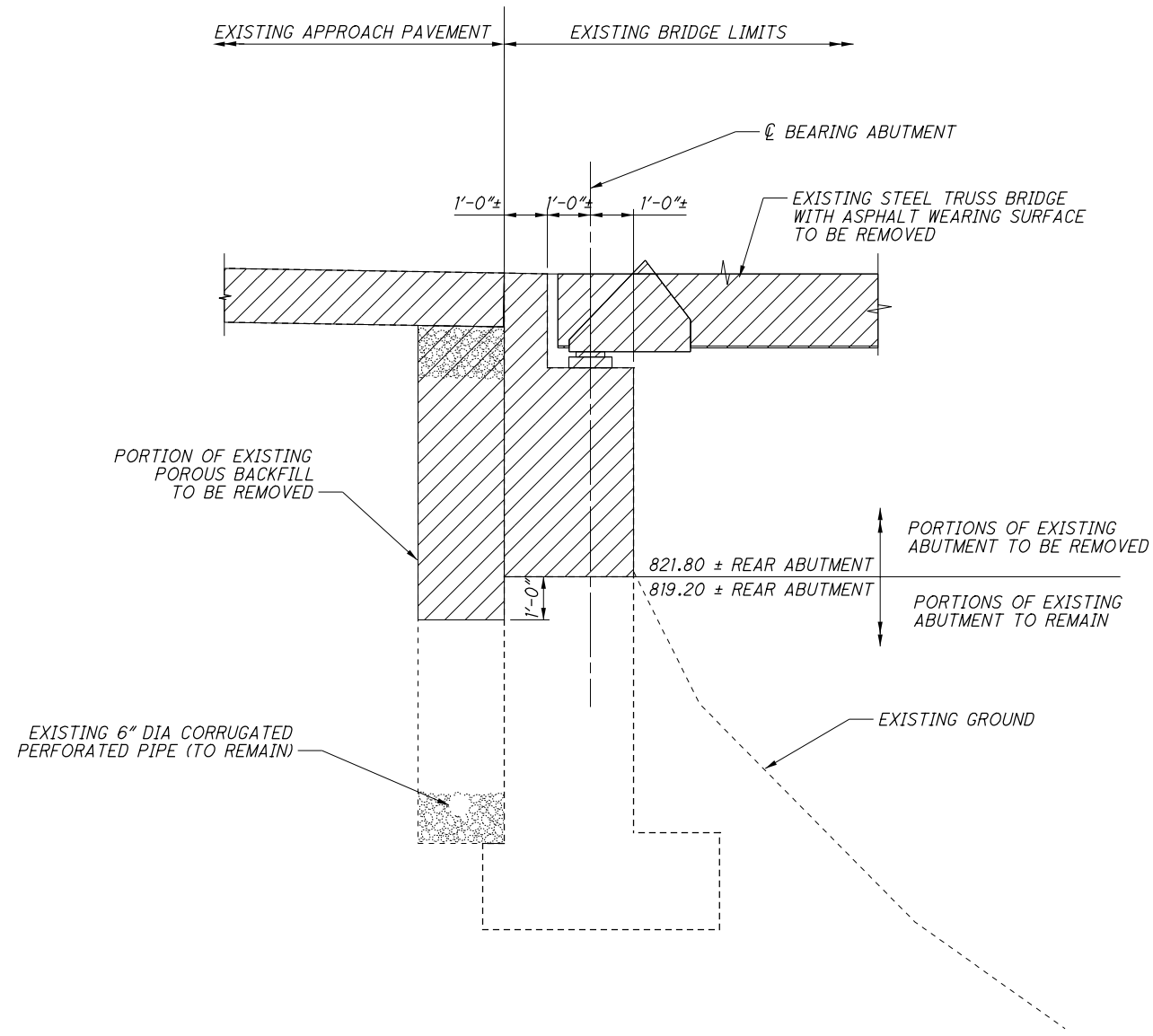

| | | | | | | | |
|---|--|-------|-----------------------------------|-------------------------|---|---------------|---|
| GRE-T0120-0079 OLD STAGE ROAD OVER BEAR RUN | ABUTMENT TYPICAL SECTION GRE-T0120-00790 | | DESIGNED NRP CHECKED JLM | DRAWN NRP REVISED | REVIEWED DWS STRUCTURE FILE NUMBER 2932717 | DATE 08-18 | DESIGN AGENCY LIB Inc. • 2500 Newmark Drive Marietta, OH 45754 1937 295-5000 (tel) • (937) 295-5100 (fax) • libinc.com |
| | 3 / 4 | 4 / 5 | | | | | |

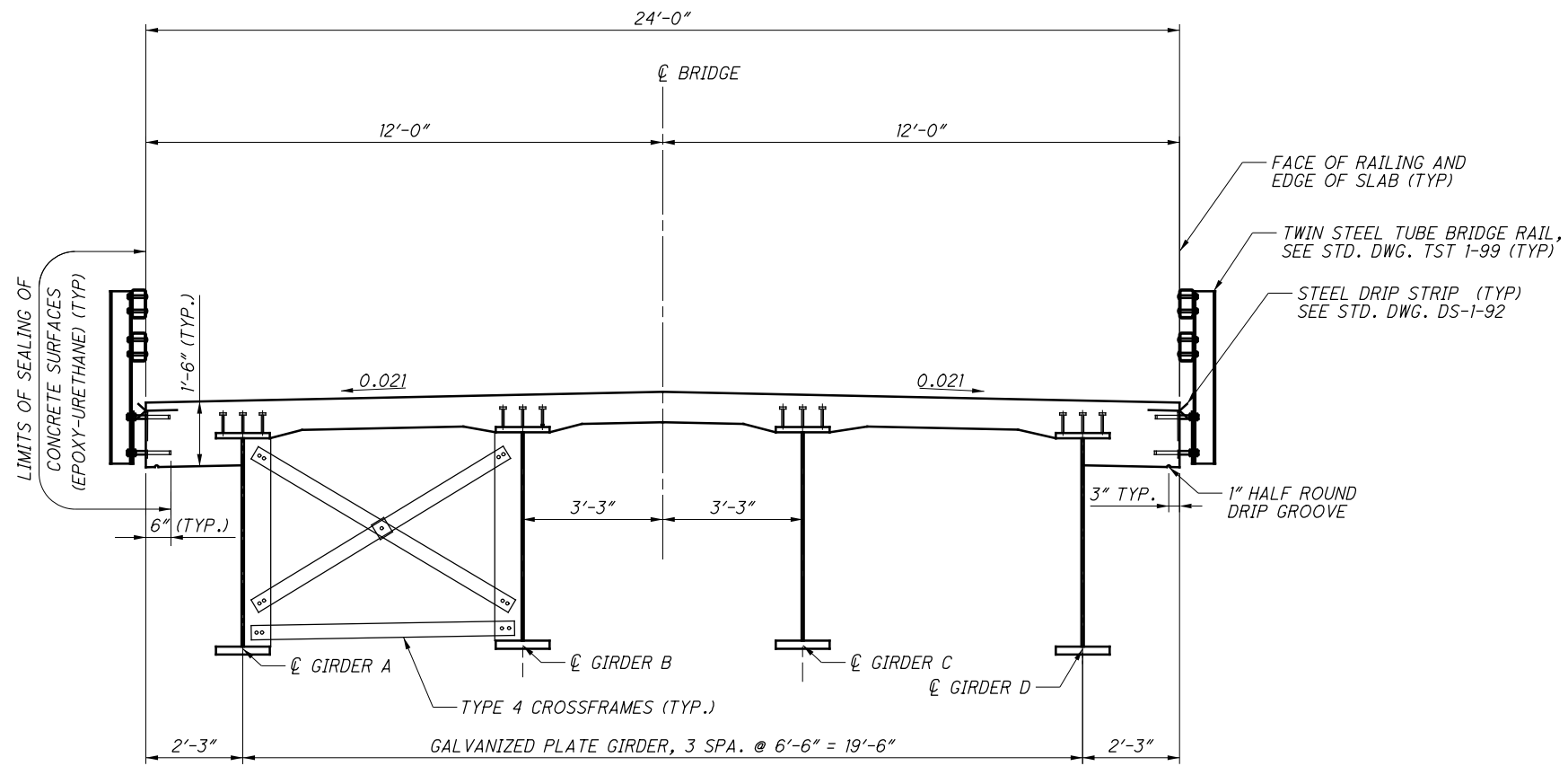

TYPICAL SECTION

| | | | | | | | | | |
|------------------------|--|--------------|--|----------------------------------|------------------------------|---------------|--|--|--|
| DESIGNED NRP | | DRAWN NRP | | REVIEWED DWS | | DATE 08-18 | | DESIGN AGENCY LIB Inc. • 2500 Newmark Drive Miamisburg, OH 45342 937 295-0000 tel • 937 295-5100 fax • libinc.com | |
| CHECKED JLM | | REVISED | | STRUCTURE FILE NUMBER 2932717 | | | | | |
| TYPICAL SECTION | | | | | GRE-T0120-00790 | | | | |
| GRE - T0120-0079 | | | | | OLD STAGE ROAD OVER BEAR RUN | | | | |
| 4 / 4 | | 5 / 5 | | | | | | | |